

VOLUME JUMPER

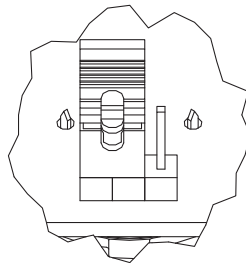

HIGH

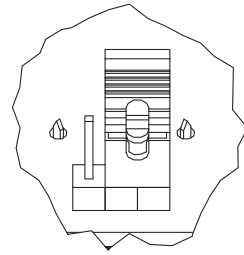

LOW

VIEW A

INSTALLATION INSTRUCTIONS

1. Rotate the button lever clockwise to the stop (as shown) so it is pointed toward the inside of the Stopper Station Shield.
2. With shield rotated to open position (approximately 90° to cover), insert shield pivots into slots on Stopper Station cover.
3. Place the volume jumper to desired sounder volume (see above).
4. Insert PCB fully into PCB guides.
5. Rotate cover to closed position.
6. Rotate cover to fully open position then back to closed position to ensure the Button Lever is pressed down onto the button. (If not, remove PCB and repeat steps 4 and 5.)
7. Pull off the plastic battery tab with the battery remaining installed (sounder is now active).
8. Mount cover with shield onto contact assembly.
9. Install bottom screw to hold cover to contact assembly.

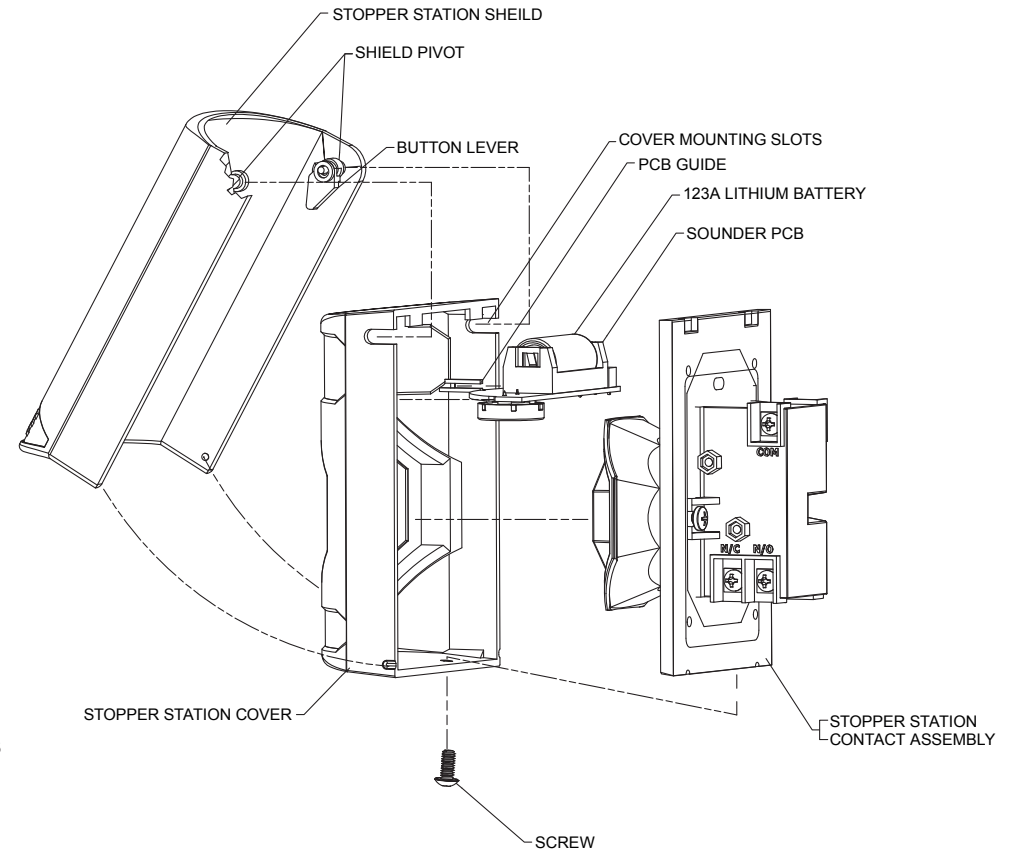

Three year warranty or a one year limited warranty (from date of purchase) on most products. See website for details. Electronic warranty form at www.sti-usa.com/wc14.



INSTALLATION OF STI-6517A STI STOPPER® STATION SHIELD AND SOUNDER
All specifications and information shown were current as of publication and are subject to change without notice.

6517AIS FEB2017

